

## Absolute Encoder Type RA 59 (stainless steel)

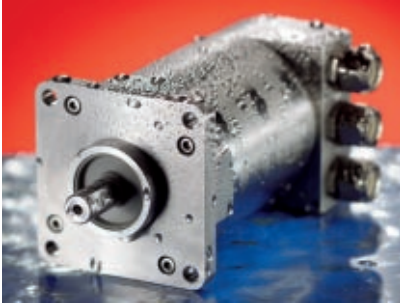

Version with bus terminal box



Version with connection cable

- Stainless steel encoder with high protection class
- High corrosion resistance
- Cable versions
- Fieldbus versions with bus terminal box
- Applications:
  - packaging machines in food area
  - ship equipment (e.g. cranes, winches, cable laying ships)
  - offshore applications

### Variants

The stainless steel encoder is available in following versions:

- Single- or multiturn with cable radial and the interfaces Parallel, SSI, INTERBUS
- Single- or multiturn with bus terminal box and the interfaces CAN, CANopen, Profibus DP, INTERBUS

### Ordering data

|  |  |   |                           |   |
|--|--|---|---------------------------|---|
| Version <sup>1)</sup><br>S Singleturn<br>M Multiturn<br>P Programmable | Supply voltage <sup>1)</sup><br>A 5 VDC<br>E 10 ... 30 VDC | Mounting<br>Q Square flange 63.5 x 63.5 | Shaft diameter<br>2 10 mm | Interface<br>P Parallel<br>S SSI<br>I INTERBUS<br>C CAN<br>O CANopen<br>D Profibus DP |
|--|--|---|---------------------------|---|

|  |  |                             |   |  |
|--|--|-----------------------------|---|--|
| Resolution <sup>1)</sup><br>0360 360 Incr. (S)<br>0009 9 Bit (S)<br>0720 720 Incr. (S)<br>0010 10 Bit (S, P)<br>3600 3600 Incr (S)<br>0012 12 Bit (S, P)<br>0013 13 Bit (S, P)<br>0014 14 Bit (S, P)<br>1212 24 Bit (M, P)<br>1213 25 Bit (M, P)<br>1214 26 Bit (M, P) | Output <sup>1)</sup><br>K push-pull<br>T RS 485<br>C CAN | Protection class<br>7 IP 67 | Connection <sup>1)</sup><br>B cable, radial<br>Z bus terminal box (3-fold PG), radial (integrated T-manifold) | Code <sup>1)</sup><br>B binary<br>G Gray |
|--|--|-----------------------------|---|--|

<sup>1)</sup> Code letter is depending on interface.  
Possible combinations are described in the encoder catalogue (refer to specific interface chapter).

## Type RA 59 (stainless steel)

### Technical Data

mechanical

|                                |  |
|--------------------------------|--|
| Flange                         | Square flange 63.5 x 63.5 mm   |
| Shaft diameter                 | 10 mm  |
| Absolute max. speed            | 10000 min <sup>-1</sup>  |
| Torque                         | ≤1 Ncm   |
| Moment of inertia              | 20 gcm <sup>2</sup> approx.  |
| Protection class (EN 60529)    | housing IP 67, bearings IP 67  |
| Operating temperature          | -25 ... +85 °C (Interbus -10 ... +60 °C)   |
| Storage temperature            | -25 ... +85 °C   |
| Vibration proof (IEC 68-2-6)   | 100 m/s <sup>2</sup> (10 ... 500 Hz)   |
| Shock resistance (IEC 68-2-27) | 1000 m/s <sup>2</sup> (6 ms)   |
| Connection radial              | 1,5 m cable <sup>1)</sup> or bus terminal box  |
| Housing                        | stainless steel 1.4305   |
| Mounting length                | cable version: singleturn 55, multiturn 82.5<br>bus terminal box: singleturn 89, multiturn 110 |

<sup>1)</sup> Other cable length on request

### Technical Data

electrical

The electrical datas depend on type of interface.

They are listed in the encoder catalogue. Please refer to the specific interface chapter.

### Dimensioned drawing

Version with bus terminal box

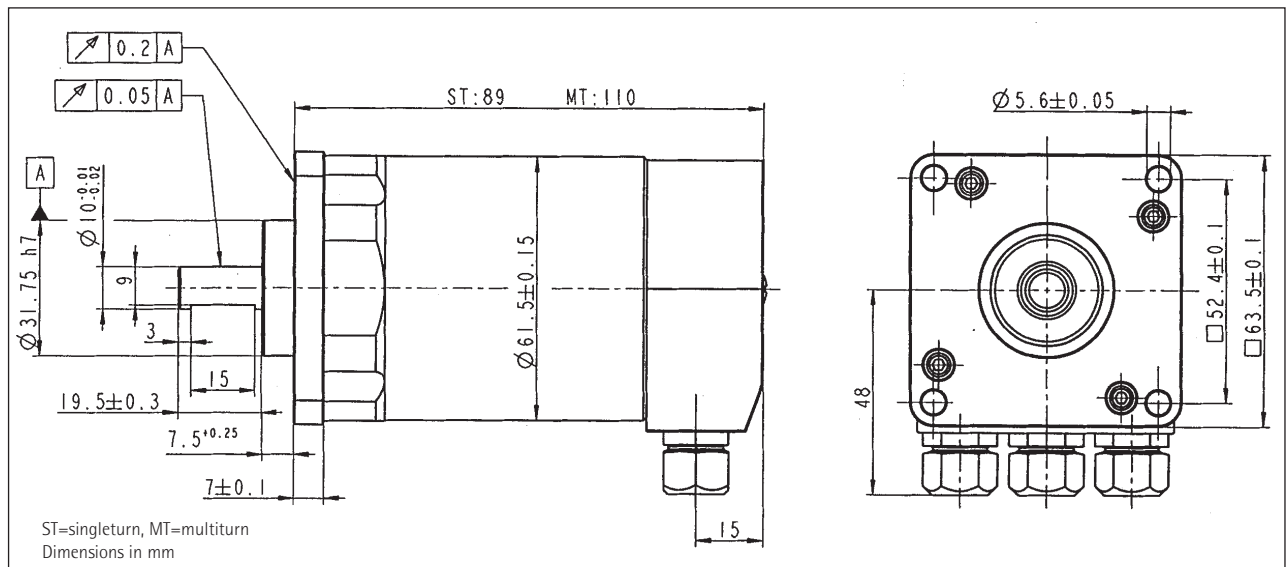

# HENGSTLER

HENGSTLER GmbH  
Postfach 11 51  
78 550 Aldingen  
Germany  
Tel.: +49-74 24/8 95 39  
Fax: +49-74 24/8 93 70  
<http://www.hengstler.de>  
e-mail: [info@hengstler.de](mailto:info@hengstler.de)



DOC 1237.00 E